

CROSSWAVE™

USER GUIDE
1713Z

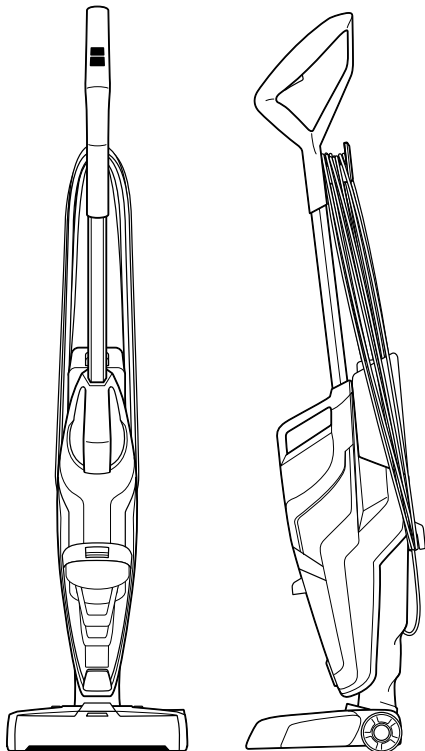

IMPORTANT SAFETY INSTRUCTIONS

READ ALL INSTRUCTIONS BEFORE USING YOUR MULTI-SURFACE CLEANER.

When using an electrical appliance, basic precautions should be observed, including the following.

WARNING

ALWAYS CONNECT TO A PROPERLY EARTHED ELECTRICAL SOCKET.

WARNING

TO REDUCE THE RISK OF FIRE, ELECTRIC SHOCK, OR INJURY:

- » Unplug from electrical socket when not in use and before cleaning, maintaining or servicing the appliance.
- » This appliance can be used by children aged from 8 years and above and persons with reduced physical, sensory or mental capabilities or lack of experience and knowledge if they have been given supervision or instruction concerning use of the appliance in a safe way and understand the hazards involved. Cleaning and user maintenance shall not be made by children without supervision.
- » Children should be supervised to ensure that they do not play with the appliance.
- » If the supply cord is damaged, it must be replaced by the manufacturer, its service agent or similarly qualified persons in order to avoid a hazard.
- » Do not run appliance over cable.
- » Keep hair, loose clothing, fingers, and all parts of body away from openings and moving parts of the appliance and its accessories.
- » Use only the type and amount of liquids specified under the Operations section of this guide.
- » Do not leave appliance when plugged in.
- » Do not modify earthed plug.
- » Brush may start unexpectedly. Unplug before cleaning or servicing.
- » Do not expose to rain. Store indoors.
- » Do not allow to be used as a toy.
- » Use only as described in the user guide.
- » Use only manufacturer's recommended attachments.
- » Do not use with damaged cable or plug.
- » Do not immerse in water or liquid.
- » If appliance is not working as it should, has been dropped, damaged, left outdoors, or dropped into water; do not attempt to operate it and have it repaired at an authorised service center.

- » Liquid must not be directed towards equipment containing electrical components.
- » Do not pull or carry by cable, use cable as a handle, close door on cable, or pull cable around sharp edges or corners.
- » Keep cable away from heated surfaces.
- » Do not unplug by pulling on cable.
- » To unplug, grasp the plug, not the cable.
- » Do not handle plug or appliance with wet hands.
- » Do not put any object into openings.
- » Do not use with any opening blocked; keep free of dust, lint, hair, and anything that may reduce air flow.
- » Turn off all controls before unplugging.
- » Use extra care when cleaning on stairs.
- » Do not use to pick up flammable or combustible liquids, such as petrol, or use in areas where they may be present.
- » Do not pick up toxic material (chlorine bleach, ammonia, drain cleaner, etc.)
- » Do not use appliance in an enclosed space filled with vapors given off by oil base paint, some mothproofing substances, flammable dust, or other explosive or toxic vapors.
- » Do not pick up hard or sharp objects such as glass, nails, screws, coins, etc.
- » Keep appliance on a level surface.
- » Plastic film can be dangerous. To Avoid danger of suffocation, keep away from children.

WARNING

TO REDUCE THE RISK OF INJURY FROM MOVING PARTS, CORRECTLY ASSEMBLE THE BRUSH WINDOW IN PLACE BEFORE OPERATION.

WARNING

TO REDUCE THE RISK OF FIRE AND ELECTRIC SHOCK, USE INDOORS ONLY. DO NOT IMMERSE. USE ONLY ON SURFACES MOISTENED BY THE CLEANING PROCESS. USE ONLY BISSELL CLEANING PRODUCTS INTENDED FOR USE WITH THIS MACHINE.

WARNING

TO REDUCE THE RISK OF FIRE AND ELECTRIC SHOCK, ALWAYS INSTALL FLOAT BEFORE ANY WET PICK-UP OPERATION.

SAVE THESE INSTRUCTIONS

FOR OPERATION ON A 220-240 VOLT A.C. 50-60 HZ POWER SUPPLY ONLY.

This model is for household use only.

BISSELL[®] Since 1876

Thanks for buying a BISSELL CrossWave™

We love to clean and we're excited to share one of our innovative products with you. We want to make sure your multi-surface cleaner works as well in two years as it does today, so this guide has tips on using (pages 6-7) and maintaining (pages 8-11) your CrossWave™.

Your multi-surface cleaner needs a little assembly before you can put it to work, so flip to page 5 and let's get started!

What's In The Box?

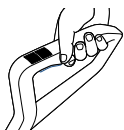

Handle



Dual Action
Multi-Surface
Brush Roll



Multi Surface
Formula

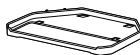

Storage Tray



Brush Roll
Drying Tray

NOTE: Standard accessories may vary by model. To identify what should be included with your purchase, please refer to the "Carton Contents" list located on the carton top flap.

Safety Instructions.....2

Maintenance & Care8-11

Product View.....4

Guarantee..... 12

Assembly5

Consumer Care..... 12

Operations6-7

Getting to Know Your CrossWave™

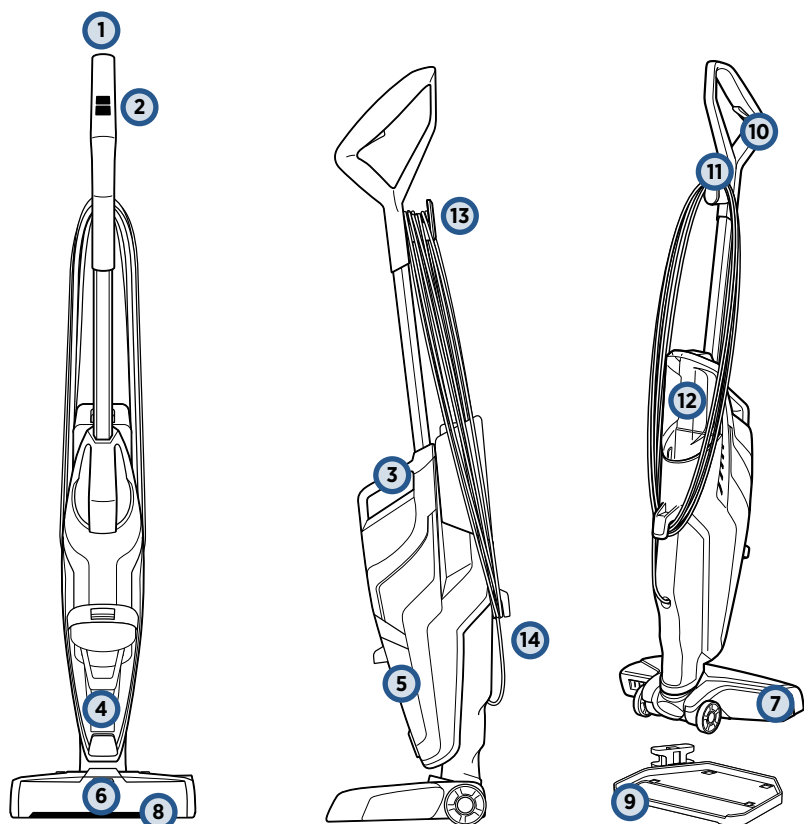

- | | |
|---------------------------------|----------------------------|
| 1 Upper Handle | 8 Easy Remove Brush Window |
| 2 SmartClean Fingertip Controls | 9 Easy Clean Storage Tray |
| 3 Integrated Carrying Handle | 10 Solution Spray Trigger |
| 4 Float Stack | 11 In-Use Cord Clip |
| 5 Dirty Water Tank | 12 Clean Water Tank |
| 6 Solution Spray Indicator LED | 13 Quick Release Cord Wrap |
| 7 Foot | 14 Lower Cord Wrap |

Assembly

⚠ WARNING

Do not plug in your CrossWave™ until you are familiar with all instructions and operating procedures.

Your BISSELL CrossWave™ machine comes in three easy to assemble components and does not require any tools to assemble. The unit also comes with a two-piece Easy Clean Storage Tray.

- Handle
- Body
- Clean Water Tank
- Storage Tray
- Brush Roll Drying Tray

1

Insert handle into body of unit until you hear a click.

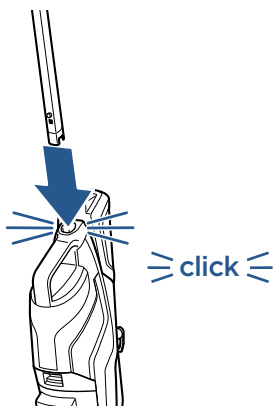

2

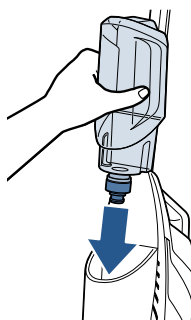

Then, on the back of the machine, align clean water tank with the grooves and slide tank into place until you hear a click.

3

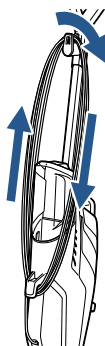

Wrap the cord around the quick release cord wrap and the lower cord wrap.

4

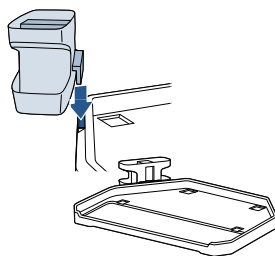

The Easy Clean Storage Tray consists of a machine storage tray and a brush roll drying tray. To assemble the Easy Clean Storage Tray, align arrows on the storage tray with the arrows on the brush roll drying tray and slide into place.

NOTE: To easily unwrap the cord for use, just turn the quick release cord wrap downward to remove the cord from the cord wrap.

Filling Your Clean Water Tank

1

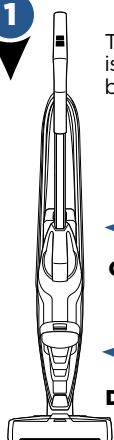

The clean water tank is located on the back of the machine.

Clean Water Tank

Dirty Water Tank

2

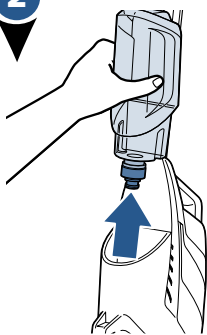

Lift the clean water tank straight up to remove from the machine.

3

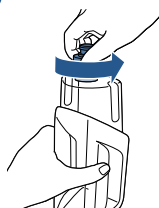

Unscrew the cap from the clean water tank.

The clean water tank has two measuring volumes depending on the amount of space you would like to clean.

4



BISSELL Multi-Surface, BISSELL Wood Floor

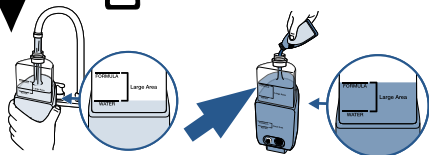

For large area cleaning (up to 55 sq m)

- Fill formula tank with hand hot tap water to the second water fill line.
- Then add formula to the second formula fill line.

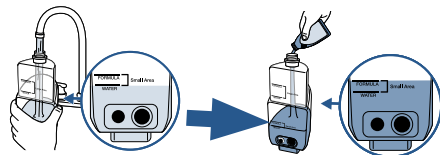

For small area cleaning (<27 sq m)

- Fill formula tank with hand hot tap water to the first water fill line.
- Then add formula to the first formula fill line.

5

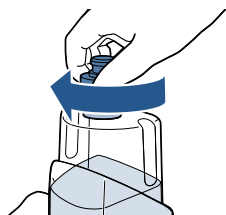

Screw the cap back onto the clean water tank.

6

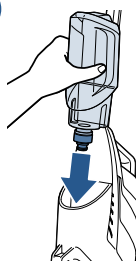

On the back of the machine, align clean water tank with the grooves and slide tank into place until you hear a click.

A few notes about filling the clean water tank:

- Fill with hand hot (140°F/60°C MAX) tap water and add the appropriate BISSELL solution. **DO NOT USE BOILING WATER. DO NOT HEAT WATER OR TANK IN MICROWAVE.**

Cleaning Hard Floors & Area Rugs

NOTE: Before you begin, plug the machine into a properly grounded outlet.

NOTE: Before cleaning area rugs, test an inconspicuous area of the rug for colorfastness. Also, please check manufacturer's tag before cleaning area rugs for any specialised cleaning instructions. Not for use on silk or delicate area rugs.

1

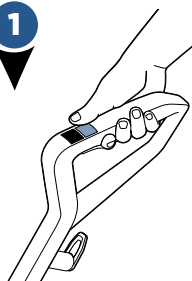

Select cleaning mode:

To start cleaning, turn the machine ON in the **HARD FLOOR** or **AREA RUG** setting. Once the setting is selected, the dry vacuum will turn on. To turn OFF, press the **HARD FLOOR** or **AREA RUG** setting a second time.

2

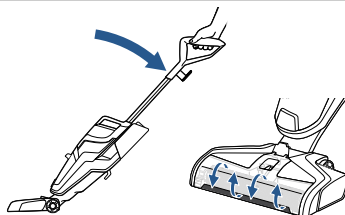

Recline the body of the machine backward to start the brush roll spinning. To stop the brush roll spinning, you will need to stand the machine upright.

3

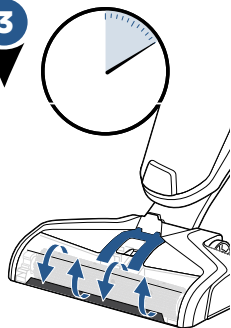

Before each use, hold the solution spray trigger for 10 seconds to prime the system with cleaning solution. LED lights illuminate when holding the trigger.

NOTE: When solution is flowing, you will see bubbles forming at the edges of the brush roll window.

4



To clean, hold the solution spray trigger to apply solution on both forward and backward passes.

NOTE: Hold machine over stuck on messes while holding the trigger for best results.

NOTE: The RUG button dispenses twice the solution of the HARD FLOOR button to help with area rug cleaning.

5

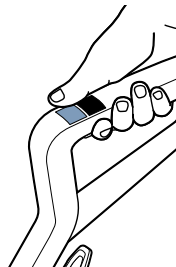

For overly challenging and stuck-on messes on your hard floors, activate the **RUG** mode and hold your CrossWave™ over the mess.

Using short passes while holding the trigger allows the multi-surface brush to go to work.

To dry area rugs faster, run the machine over your area rug without holding the trigger.

ATTENTION

Do not over wet carpet. Be careful not to run over loose objects or edges of area rugs. Stalling the brush may result in premature belt failure.

Maintenance: Empty Dirty Water Tank

⚠ WARNING

To reduce the risk of fire, electric shock or injury, turn power OFF and disconnect plug from electrical outlet before performing maintenance or troubleshooting.

1

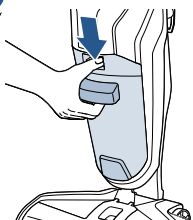

To release dirty water tank, press down on recessed button on the top of the dirty tank.

2

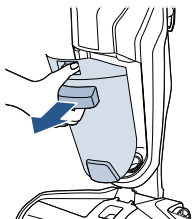

Grab the front handle while pressing down on button and pull dirty water tank away from the unit.

3

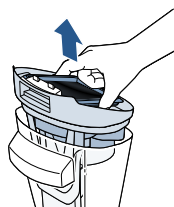

Grasp top of dirty water tank in recessed areas on each side of the filter and pull upward to remove the top of the tank.

Did You Know?

The Float is what prevents your dirty tank from overflowing. When your dirty tank is full, the float will shut off your suction motor creating a high pitched sound indicating it is time to empty your dirty water tank.

4

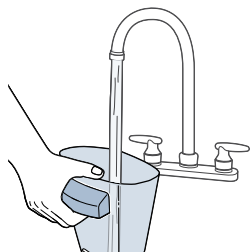

Pour dirty water and debris out. Rinse the inside of the dirty water tank.

5

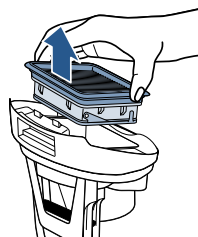

Remove the filter from the dirty water tank top by pulling it up.

6

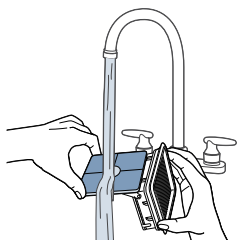

Hand wash the vacuum filter and screen with warm water and mild detergent.

7

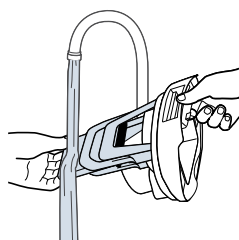

Rinse the float located at the bottom of the dirty water tank's top.

Maintenance: Empty Dirty Water Tank

WARNING

To reduce the risk of fire, electric shock or injury, turn power OFF and disconnect plug from electrical outlet before performing maintenance or troubleshooting.

8

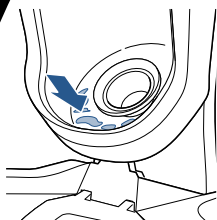

If the inside area where the dirty water tank sits is dirty, wipe it clean with a rag or towel.

9

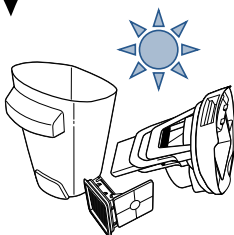

Leave parts out to dry.

10

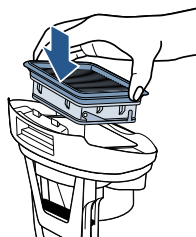

Place vacuum filter back into dirty water tank top.

NOTE: Make sure to clean your dirty tank and let all components dry out after each use to keep your product at its best.

11

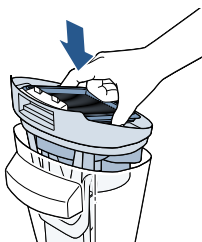

Once parts are dry, reassemble and replace the top of dirty water tank.

12

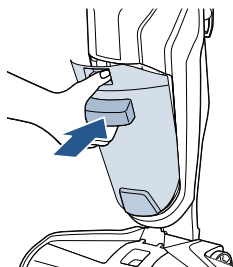

Angle the dirt tank back into body of machine inserting bottom first. Then tilt the top of the dirt tank toward the machine and push into place until you hear a click.

Maintenance: Cleaning the Brush Roll and Brush Chamber

WARNING

To reduce the risk of fire, electric shock or injury, turn power OFF and disconnect plug from electrical outlet before performing maintenance or troubleshooting.

NOTE: Before you begin, turn off the machine and unplug it from the outlet.

1

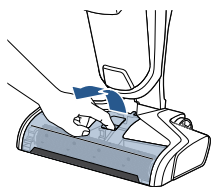

Grasp brush roll window at the front and pull upward to remove.

2

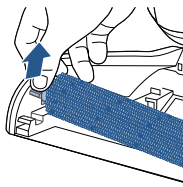

Pull brush roll out by grabbing the brush roll tab and pulling upward.

3

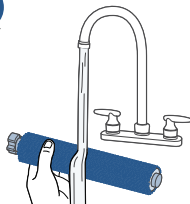

With warm water, rinse your brush roll window and brush roll.

4

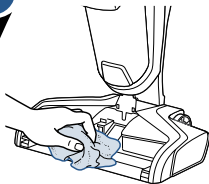

If your brush roll chamber is dirty, clean with a rag or towel.

5

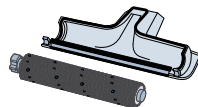

Let your brush roll and brush roll window chamber dry before reassembling.

6

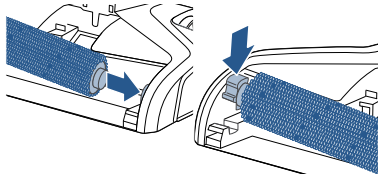

Replace brush roll by inserting the brush roll end into the right side of the foot. Then lock the pull tab into place by pressing downward.

7

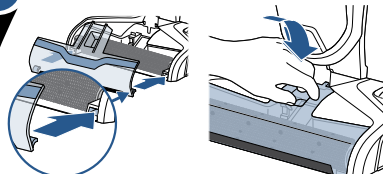

Replace the brush roll window by first lining up the brush window tabs with the edges of the foot. Then press the window back into place until you hear a click.

Maintenance: Easy Clean Storage Tray

WARNING

To reduce the risk of fire, electric shock or injury, turn power OFF and disconnect plug from electrical outlet before performing maintenance or troubleshooting.

1

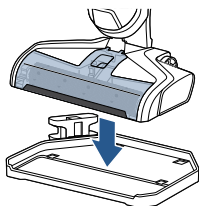

Place unit on self-cleaning storage tray.

2



Pour water to the MAX line of the self-cleaning storage tray.

3

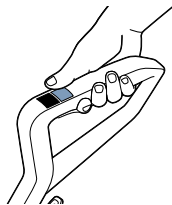

Turn the machine on by pressing the Hard Floor button.

4

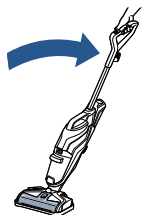

Recline the machine while in storage tray. Allow the machine to run for 10-15 seconds until all water is picked up. Repeat as needed.

5



Turn the machine off and unplug it from the outlet. Grasp brush roll window at the front of the window and pull upward to remove.

6

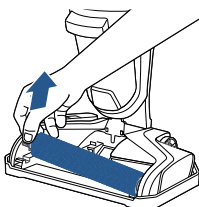

Pull brush roll out by grabbing the brush roll tab and pulling upward.

7

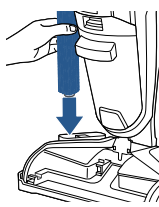

Place the brush roll upright in the Brush Roll Drying Tray to dry.

8

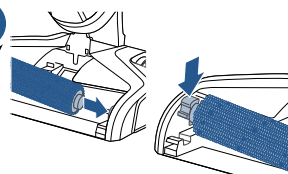

Replace brush roll by inserting the brush roll end into the right side of the foot. Then lock the pull tab into place by pressing downward.

9

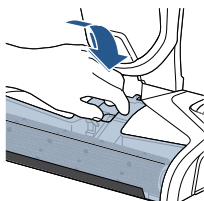
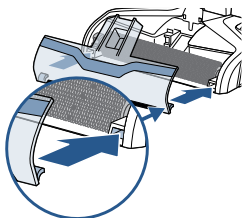

Replace the brush roll window by first lining up the brush window tabs with the edges of the foot. Then press the window back into place until you hear a click.

Consumer Guarantee

This Guarantee only applies outside of the USA and Canada. It is provided by BISSELL International Trading Company BV ("BISSELL").

This Guarantee is provided by BISSELL. It gives you specific rights. It is offered as an additional benefit to your rights under law. You also have other rights under law which may vary from country to country. You can find out about your legal rights and remedies by contacting your local consumer advice service. Nothing in this Guarantee will replace or lessen any of your legal rights or remedies. If you need additional instruction regarding this Guarantee or have questions regarding what it may cover, please contact BISSELL Consumer Care or contact your local distributor.

This Guarantee is given to the original purchaser of the product from new and is not transferable. You must be able to evidence the date of purchase in order to claim under this Guarantee.

Limited 2 Year Guarantee from the date of purchase by original purchaser

Subject to the *EXCEPTIONS AND EXCLUSIONS identified below, BISSELL will repair or replace (with new, refurbished, lightly used, or remanufactured components or products), at BISSELL's option, free of charge, any defective or malfunctioning part or product.

BISSELL recommends that the original packaging and evidence of the date of purchase be kept for the duration of the Guarantee period in case the need arises within the period to claim on the Guarantee. Keeping the original packaging will assist with any necessary re-packaging and transportation but is not a condition of the Guarantee.

If your product is replaced by BISSELL under this Guarantee, the new item will benefit from the remainder of the term of this Guarantee (calculated from the date of the original purchase). The period of this Guarantee shall not be extended whether or not your product is repaired or replaced.

*EXCEPTIONS AND EXCLUSIONS FROM THE TERMS OF THE GUARANTEE

This Guarantee applies to products used for personal domestic use and not commercial or hire purposes. Consumable components such as filters, belts and mop pads, which must be replaced or serviced by the user from time to time, are not covered by this Guarantee.

This Guarantee does not apply to any defect arising from fair wear and tear. Damage or malfunction caused by the user or any third party whether as a result of accident, negligence, abuse, neglect, or any other use not in accordance with the User Guide is not covered by this Guarantee.

An unauthorised repair (or attempted repair) may void this Guarantee whether or not damage has been caused by that repair/attempt.

Removing or tampering with the Product Rating Label on the product or rendering it illegible will void this Guarantee.

SAVE AS SET OUT BELOW BISSELL AND ITS DISTRIBUTORS ARE NOT LIABLE FOR ANY LOSS OR DAMAGE THAT IS NOT FORESEEABLE OR FOR INCIDENTAL OR CONSEQUENTIAL DAMAGES OF ANY NATURE ASSOCIATED WITH THE USE OF THIS PRODUCT INCLUDING WITHOUT LIMITATION LOSS OF PROFIT, LOSS OF BUSINESS, BUSINESS INTERRUPTION, LOSS OF OPPORTUNITY, DISTRESS, INCONVENIENCE OR DISAPPOINTMENT. SAVE AS SET OUT BELOW BISSELL'S LIABILITY WILL NOT EXCEED THE PURCHASE PRICE OF THE PRODUCT.

BISSELL DOES NOT EXCLUDE OR LIMIT IN ANY WAY ITS LIABILITY FOR (A) DEATH OR PERSONAL INJURY CAUSED BY OUR NEGLIGENCE OR THE NEGLIGENCE OF OUR EMPLOYEES, AGENTS OR SUBCONTRACTORS; (B) FRAUD OR FRAUDULENT MISREPRESENTATION; (C) OR FOR ANY OTHER MATTER WHICH CANNOT BE EXCLUDED OR LIMITED UNDER LAW.

Consumer Care

If your BISSELL product should require service or to claim under our limited guarantee, please contact us as follows:

Website:

www.BISSELL.cn

Email:

BISSELL.cn/contact

Mail:

BISSELL Healthy Home Products (Shenzhen) Co., Ltd.
401, 4/F, Block 1, Building E,
Chiaphua Industrial Park,
Shui Tian Community,
Shi Yan Street, Bao'an District,
Shenzhen, Guangdong, China

For Mainland China Inquiries:

4000.860.369
Monday – Friday

Visit the BISSELL website: www.BISSELL.cn

When contacting BISSELL, have model number of cleaner available.

Please record your Model Number: _____ Please record your Purchase Date: _____

NOTE: Please keep your original sales receipt. It provides proof of the date of purchase in the event of a Guarantee claim. See Guarantee for details.



©2017 BISSELL Homecare, Inc.
Grand Rapids, Michigan
All rights reserved. Printed in China
Part Number 161-4090 12/17 RevC
Visit our website at: www.BISSELL.cn

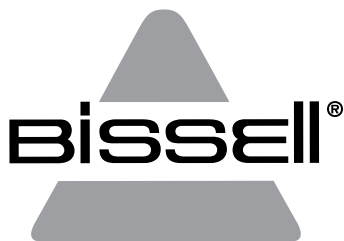

CROSSWAVE™

吸洗二合一全地面清洁机

使用手册

1713Z

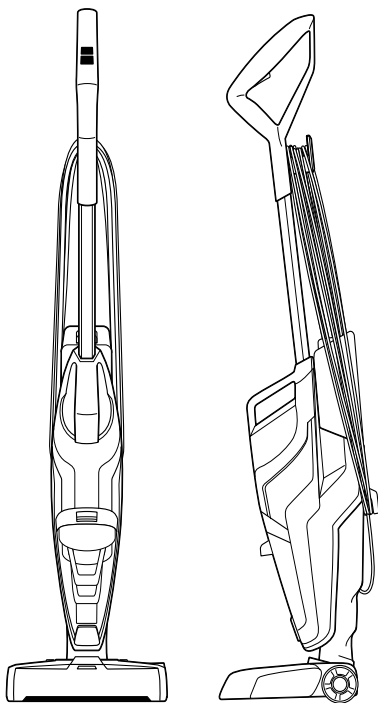

重要安全须知

在使用多功能清洁机之前，请先阅读所有安全须知。

使用电气设备时，应遵照基本预防措施，包括以下内容：

警告

务必连接至正确接地的电源插座。

警告

为降低火灾、电击或伤害风险，请遵照以下要求操作：

- » 不用时以及在清洁、维护或维修本机之前，应将插头从电源插座中拔出。
- » 本机可由 8 岁及以上的儿童，以及身体、感官或心智机能不健全者或者缺乏经验和了解的人员使用，但前提是有人监护他们，或告知他们本机的安全使用方法及相关危险。在无人监护的情况下，不得由儿童执行清洁和用户维护操作。
- » 应监护好儿童，确保其不会玩要本机。
- » 如果电源线损坏，必须由制造商及其维修机构或类似有资格的人员更换，以免发生危险。
- » 请勿让本机压过电缆。
- » 确保头发、宽松的衣服、手指以及身体的各个部位远离本机的开口和移动部分及其配件。
- » 仅使用本手册“操作”部分所规定的液体类型，且用量要符合规定。
- » 插上插头时，切勿让本机处于无人看管的状态。
- » 切勿改装接地插头。
- » 毛刷可能会意外启动。清洁或维修之前，请先拔出插头。
- » 切勿淋雨。请在室内存放。
- » 切勿当做玩具使用。
- » 务必按本使用手册中的规定使用本机。
- » 务必使用制造商推荐的配件。
- » 切勿使用损坏的电缆或插头。
- » 切勿浸入水中或液体中。
- » 如果本机无法正常工作、曾掉落在地上、已损坏、曾置于室外或掉落在水中，请勿尝试进行操作，而应将其送至授权维修中心进行修理。

- » 不得将液体导入到包含电气部件的设备中。
- » 切勿拽拉电缆或通过电缆提起设备，切勿将电缆用作把手，切勿在关门时夹住电缆，切勿在锋利的边缘或拐角区域拽拉电缆。
- » 确保电缆远离受热表面。
- » 切勿通过拽拉电缆拔出插头。
- » 要拔出插头，请捏住插头，而不是电缆。
- » 切勿用湿手握持插头或本机。
- » 切勿将任何物体放入开口中。
- » 切勿在开口堵塞的情况下使用；确保无灰尘、棉绒、头发或任何可能减小气流的物体。
- » 拔出插头前，请先关闭所有控制器。
- » 清扫楼梯时应格外小心。
- » 切勿用于扫除易燃或可燃液体（例如汽油），或者在可能存在易燃或可燃液体的区域使用本机。
- » 切勿用于扫除有毒物质（氯漂白剂、氨水、下水道清洗剂等）。
- » 切勿在充满油漆所发出的蒸气、某些防蛀物质、可燃性粉尘或其他爆炸性或有毒蒸气的密闭空间内使用本机。
- » 切勿用于扫除坚硬或尖锐物品，例如玻璃、钉子、螺丝、硬币等。
- » 确保将本机放在水平表面上。
- » 塑料薄膜是危险的。为避免窒息的危险，请远离儿童。

警告

为降低被运动部件伤害的风险，在操作之前，请先将毛刷窗正确装配就位。

警告

为降低火灾和电击风险，请仅在室内使用。切勿浸入水中。仅在清洁过程中弄湿的表面上使用本机。仅使用与本机专门配套的必胜清洁产品。

警告

为降低火灾和电击风险，在潮湿工况下执行扫除操作之前，请始终安装浮子。

请保管好本安全须知，以备将来参考

仅适合在 **220-240 V 50-60 Hz** 的交流电源下操作。
本型号仅供家庭使用。

感谢您购买必胜 CrossWave™ 清洁机

我们热爱清洁事业！我们怀着无比激动的心情，与您分享我们的一款创新产品。我们希望确保您的多功能清洁机在两年内能一如既往地正常工作。为此，本手册提供了有关使用（第 18-19 页）、维护（第 20-23 页）。

在投入使用之前，您还需要对多功能清洁机进行少量的装配工作。请翻至第 17 页，让我们开始吧！

装箱清单

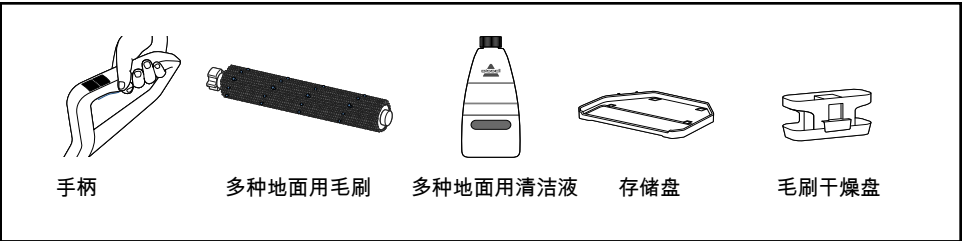

注：标准配件可能会因型号而异。要确定您所购买的产品包含了哪些配件，请参阅纸箱盒盖上的“纸箱内容”清单。

安全须知	14	维护与保养	20-23
产品视图	16	保修	24
装配	17	客户服务	24
操作	18-19		

产品中有害物质的名称及含量

部件名称	目标部件	有害物质或元素					
		铅 (Pb)	汞 (Hg)	镉 (Cd)	六价铬 (Cr (VI))	多溴联苯 (PBB)	多溴二苯醚 (PBDE)
电路板	印刷电路板，电路板上的电子零件（不包括特定电子零件）	× ⁽¹⁾	0	0	0	0	0
马达	马达外壳，轴承，线圈及相应的电子零件（不包括特定电子零件）	× ⁽¹⁾	0	0	0	0	0
其它	外壳，地刷等	0	0	0	0	0	0
本表格依据 SJ/T 11364 的规定编制							
0：表示该有害物质在该部件所有均质材料中的含量均在 GB/T 26572 规定的限量要求以下。							
X：表示该有害物质至少在该部件的某一均质材料中的含量超出 GB/T 26572 规定的限量要求。							
[1]：部件材质中有毒或有害物质含量符合欧盟 RoHS 指令的豁免项目的限制（2011/65/EU Annex II, recasting 2002/95/EC）。							



在中华人民共和国境内销售的电子电气产品上将印有“环保使用期”（EPuP）符号。
圆圈中的数字代表产品的正常环保使用年限。

了解 CrossWave™ 清洁机

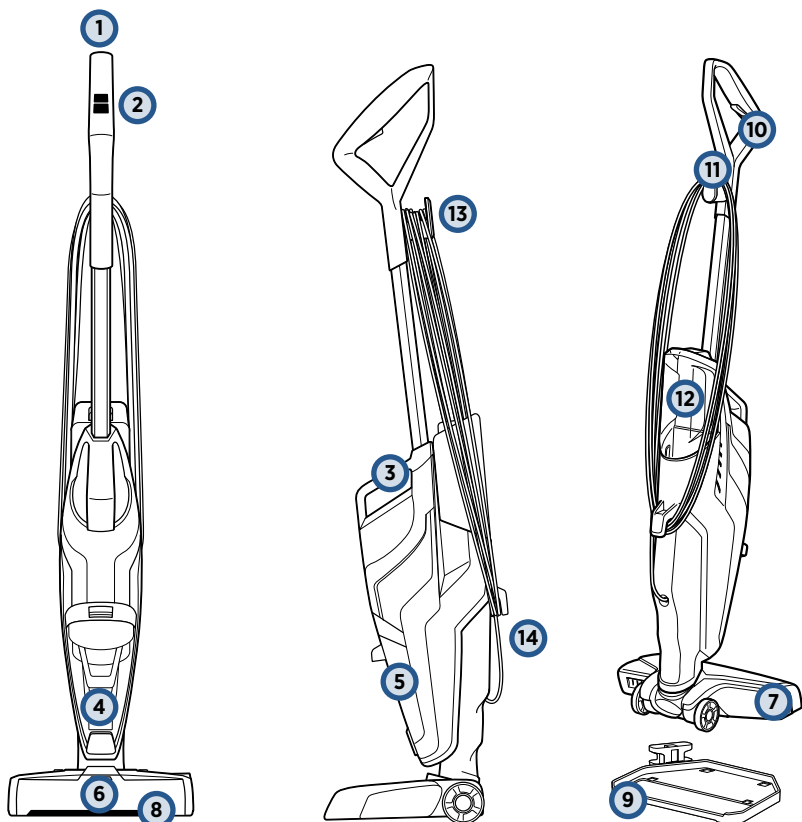

- 1 上部手柄
- 2 智能清洁控制按键
- 3 集成式手提把手
- 4 浮子架
- 5 污水箱
- 6 溶液喷射 LED 指示灯
- 7 地脚

- 8 易取毛刷透明盖/窗
- 9 易清洁型存储盘
- 10 溶液喷射扳扣
- 11 线夹
- 12 清水箱
- 13 快速释放型绕线器
- 14 下部绕线器

装配

⚠警告

在熟悉所有说明和操作过程之前，切勿接通 CrossWave™ 清洁机的电源。

必胜 CrossWave™ 清洁机附带了三个易装配的部件，无需任何工具即可完成装配。此外，本机还附带有有一个两件式易清洁型存储盘。

- 手柄
- 机身
- 清水箱
- 存储盘
- 毛刷干燥盘

1

将手柄插入本机的机身中，直至听到咔嚓声。

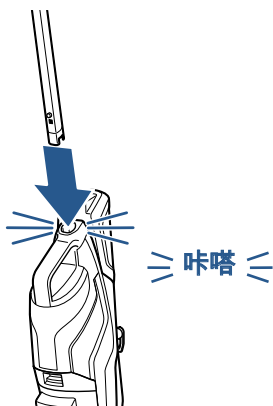

2

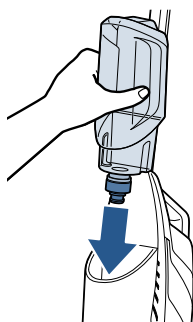

然后，在本机的背面，让清水箱与凹槽对准并将水箱推入到位，直至听到咔嚓声。

3

将电线缠绕在快速释放型绕线器和下部绕线器上。

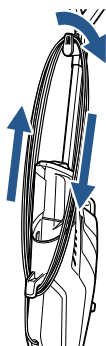

4

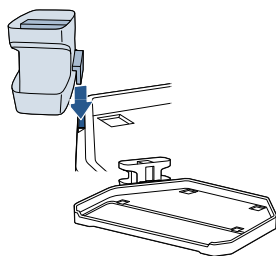

易清洁型存储盘由机器存储盘和毛刷干燥盘组成。要装配易清洁型存储盘，请将存储盘上的箭头与毛刷干燥盘上的箭头对准，然后滑动就位。

注：要在使用时轻松地释放电线，只需向下转动快速释放型绕线器，即可让绕线器上的电线散开。

加注清水箱

1

清水箱位于本机背面。

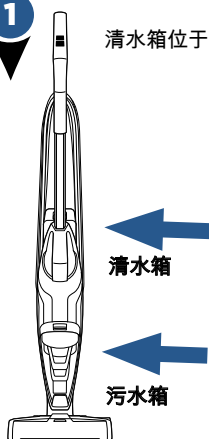

2

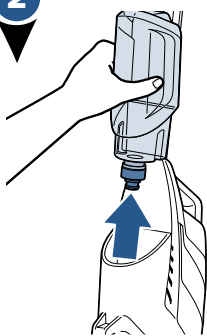

径直上提清水箱即可将其从本机上卸下。

3

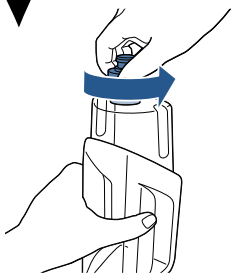

拧开清水箱的盖子。
针对所要清扫的空间大小，清水箱上设置了两个测量容积刻度。

4



BISSELL Multi-Surface, BISSELL Wood Floor

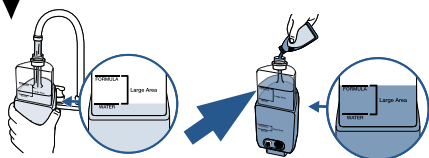

对于大面积清扫（最多 55 平方米）

- 用温自来水加注清水箱至第二根水位线。
- 之后，添加清洁液至第二根清洁液液位线。

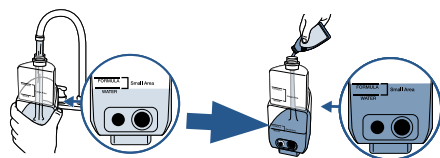

对于小面积清扫（小于 27 平方米）

- 用温自来水加注清水箱至第一根水位线。
- 之后，添加清洁液至第一根清洁液液位线。

5

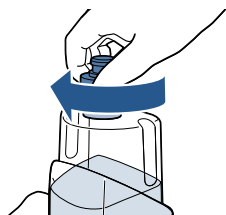

拧好清水箱的盖子。

6

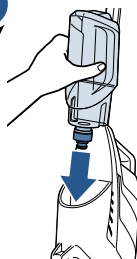

在本机的背面，让清水箱与凹槽对准，将水箱滑入就位，直至听到咔嚓声。

有关加注清水箱的几点说明：

- 请加注温自来水（最高 60°C）并添加相应的必胜清洁液。切勿使用开水。切勿在微波炉中给水或水箱加热。

清扫硬地面和小地毯

注：开始操作前，将本机的插头插入正确接地的插座中。

注：在清扫小地毯之前，应先在 carpets 不显眼的地方做一下试验，确保不会褪色。此外，在清扫小地毯之前，请检查制造商标签，以确定是否有任何专业的清扫说明。不适用于丝质或易发生损坏的小地毯。

1

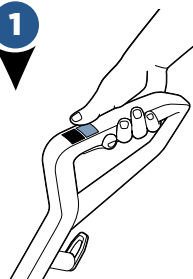

选择清扫模式：要开始清扫硬地面，请在**硬地面**或**小地毯**设置下开启本机。选择该设置后，将打开干式真空吸尘器。要关闭该功能，请再次按下**硬地面**或**小地毯**设置。

2

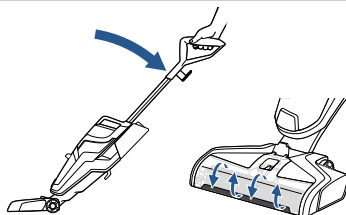

向后倾斜机身，毛刷开始旋转。要停止毛刷旋转，您需要将本机立起。

3

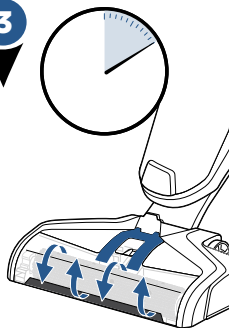

每次使用前，请扣住溶液喷射扳扣 10 秒钟，以便为系统装填清洗剂。扣住扳扣时，LED 指示灯将亮起。

注：溶液流出时，毛刷刷的边缘会出现泡沫。

4



要进行清扫，请扣住溶液喷雾扳扣，这样在向前推和向后推时都会喷出溶液。

注：请将本机置于粘附的污垢上，同时扣住扳扣，这样可获得最佳效果。

注：“地毯”按钮所分配的溶液量是“硬地面”按钮的两倍，这样有助于小地毯的清洁。

5

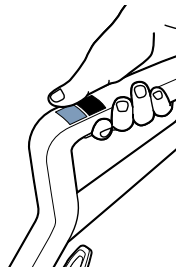

对于硬地面上极难清理的粘附污垢，请激活**地毯**模式，并将 CrossWave™ 清洁机置于污垢上。

在扣住扳扣的同时前后短距离推动几下清洁机，即可使多功能毛刷进入工作状态。

要想更快地让小地毯变干，请在不扣住扳扣的情况下用本机清扫小地毯。

小心

不要让地毯过度潮湿。小心不要清扫松散的物体或小地毯的边缘。毛刷停转可能会导致皮带过早出现故障。

维护：清空污水箱

⚠警告

为降低火灾、电击或伤害风险，在执行维护或故障排除之前，请先关闭电源，然后将插头从电源插座中拔出。

1

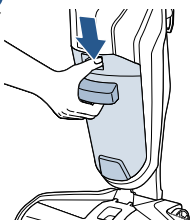

要松开污水箱，请按下污水箱顶部的下凹式按钮。

2

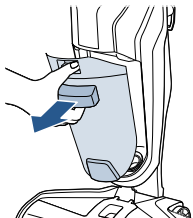

在按下该按钮的同时抓住前部把手，然后将污水箱从本机中拉出。

3

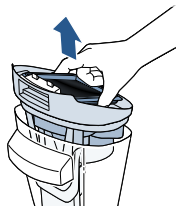

抓住污水箱顶部过滤器两侧的两个凹位，然后上拉以拆下水箱顶部。

小贴士

浮子是用于防止污水箱溢出的机构。当污水箱变满时，浮子将切断抽吸马达，同时发出高音调提示音，指示应清空污水箱了。

4

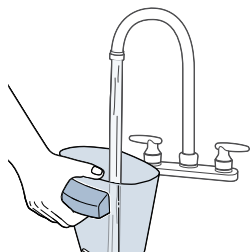

倒掉污水及碎屑。冲洗污水箱内部。

5

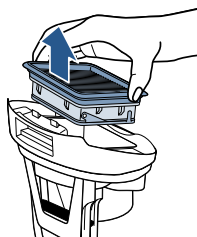

上拉滤水器，将其从污水箱顶部拆下。

6

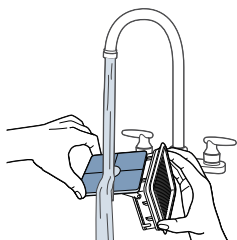

用温水和中性洗涤剂清洗真空滤水器及滤网（手洗）。

7

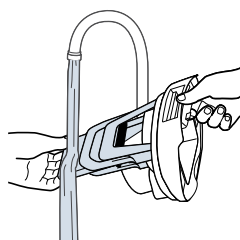

冲洗位于污水箱顶部底端的浮子。

维护：清空污水箱

⚠警告

为降低火灾、电击或伤害风险，在执行维护或故障排除之前，请先关闭电源，然后将插头从电源插座中拔出。

8

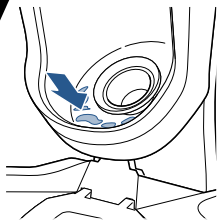

如果污水箱座的内部脏污，请用抹布或毛巾将其擦净。

9

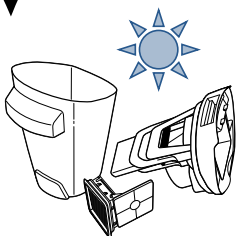

将各部件放在外面晾干。

10

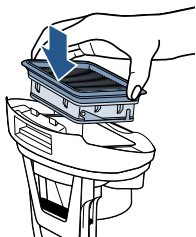

将真空滤水器放回到污水箱顶部。

注：务必在每次使用后清洁污水箱并将所有部件晾干，以确保产品处于最佳状态。

11

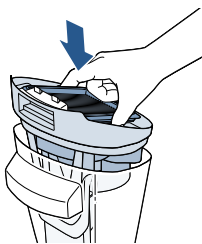

待各部件晾干后，请重新装配好并装回到污水箱顶部。

12

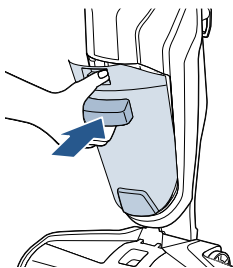

将污水箱向后倾斜插入本机的机身中，先插入底部。然后，将污水箱顶部朝本机方向倾斜并推入就位，直至听到咔嚓声。

维护：清洁毛刷和毛刷室

警告

为降低火灾、电击或伤害风险，在执行维护或故障排除之前，请先关闭电源，然后将插头从电源插座中拔出。

注：开始操作前，请关闭本机并将其插头从电源插座中拔出。

1

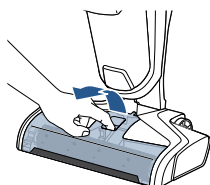

抠住毛刷窗前部并向上拉，从而将其拆下。

2

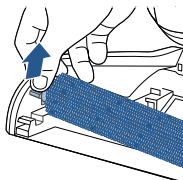

捏住毛刷耳片并向上拉，从而将毛刷拉出。

3

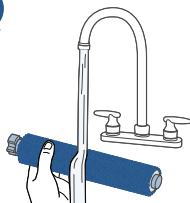

用温水冲洗毛刷窗和毛刷。

4

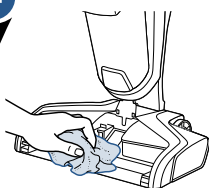

如果毛刷室脏污，请用抹布或毛巾将其擦净。

5

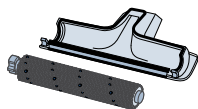

重新装配之前，先将毛刷和毛刷室晾干。

小贴士：在毛刷未干的情况下运转本机，将有助于毛刷快速变干。

6

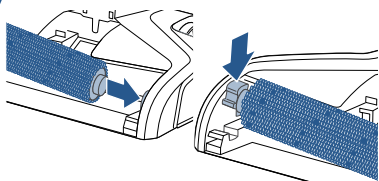

装回毛刷时，先将毛刷端部插入支脚的右侧。然后，通过下压的方式将拉片锁定就位。

7

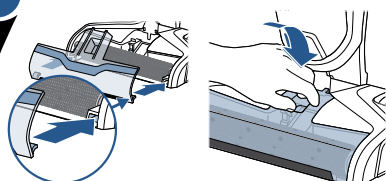

装回毛刷窗时，先将毛刷窗耳片与支脚的边缘对齐。然后，将毛刷窗向后按压就位，直至听到咔嚓声。

维护：易清洁型存储盘

警告

为降低火灾、电击或伤害风险，在执行维护或故障排除之前，请先关闭电源，然后将插头从电源插座中拔出。

1

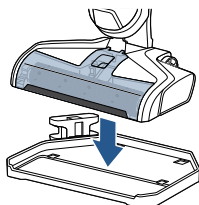

将本机放在自清洁存储盘上。

2

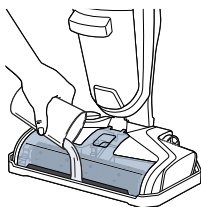

将水倒入自清洁存储盘中，至最大水位线处。

3

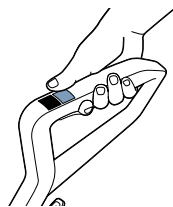

按“硬地面”按钮，开启本机。

4

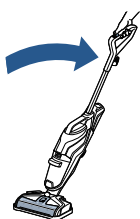

在存储盘中倾斜本机。让本机运转 10-15 秒钟，直至所有的水都被吸干。必要时可重复上述操作。

5

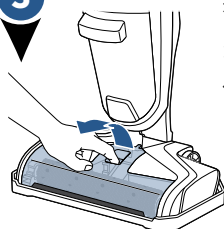

关闭本机并将其插头从电源插座中拔出。抠住毛刷窗前部并向上拉，从而将其拆下。

6

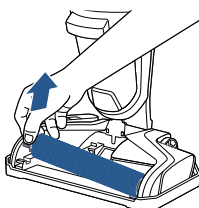

捏住毛刷耳片并向上拉，从而将毛刷拉出。

7

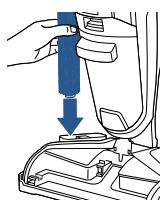

在毛刷干燥盘中直立放置毛刷，从而将其晾干。

8

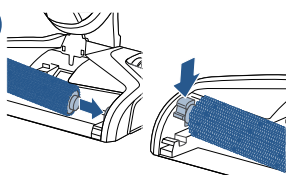

装回毛刷时，先将毛刷端部插入支脚的右侧。然后，通过下压的方式将拉片锁定就位。

9

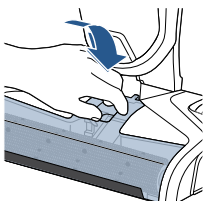
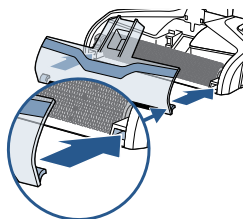

装回毛刷窗时，先将毛刷窗耳片与支脚的边缘对齐。然后，将毛刷窗向后按压就位，直至听到咔嚓声。

质保

此质保仅适用于美国和加拿大以外的国家/地区。此质保由 BISSELL International Trading Company BV (“必胜”) 提供。

此质保由必胜提供。它赋予您在法律规定权利之内的特定权利。不同国家/地区的用户所享有的法律权利也会有所不同。具体法律权利和解决方法可联系当地客户服务中心。本质保中的任何内容不会取代或减少您的法律权利或解决方法。如需有关此质保的附加说明或对其承保范围有任何疑问, 请联系必胜客户服务中心或当地的分销商。

此质保提供给新品购买者, 且不可转让。如需依据此质保进行索赔, 必须提供购买日期凭证。

两年有限质保 (自原购买者购买日期算起)

除以下“例外事项”外, 必胜有权自行决定免费维修或更换(使用新的或翻新的部件或产品)任何有缺陷或发生故障的零件或产品。

必胜建议客户在质保期内妥善保管产品原包装及购买日期凭证, 以备索赔时举证。保留原包装会方便必要的重新包装和运输, 但不是索赔的必要条件。

如果必胜在质保期内为您更换产品, 则所更换产品的质保期为本质保的剩余时间(自原购买日期算起)。无论您的产品是更换还是维修, 质保期都不会延长。

*质保条款的“例外事项”

此质保适用于个人家庭使用的产品, 不适用于商用或租赁用产品。滤水器、皮带和拖把垫等需要用户不时更换或保养的易耗品不在质保范围以内。

此质保不适用于正常磨损导致的缺陷。用户或任何第三方因事故、疏忽、滥用或其他任何不符合《使用手册》的使用行为而导致的损坏或故障不在质保范围以内。

任何未经授权的维修(或尝试维修), 无论是否造成损坏, 都可能导致此质保失效。

撕下或篡改产品标签或导致标签不可辨识会导致此质保失效。

除下列明示的事项外, 必胜及其分销商不对

不可预见的损失或损坏, 或者任何与本产品使用有关的附带和间接损失或损坏负责, 包括但不限于利润损失、商业损失、营业中断、机会损失、困境、不便或失望。除下列明示的事项外, 必胜的责任不会超过产品购买价。

必胜不会以任何形式免除或限制自身对以下事项的责任: (A) 因我方、我方员工、代理商或分包商的疏忽而导致的死亡或人身伤害; (B) 欺诈或虚假陈述; (C) 其他法律所无法免除或限制的责任。

客户服务

如果您的必胜产品需要维修或要依据两年有限保修进行索赔, 请通过以下方式联系我们:

网站:
www.BISSELL.cn

电子邮件:
BISSELL.cn/contact

欧洲地区洽询:
必胜益康家居用品(深圳)有限公司
深圳市宝安区石岩街道水田社区捷和工业城
厂房E第一栋四层401号

客户服务热线: 4000 860 369
星期一至星期五

访问必胜网站: www.BISSELL.cn

联系必胜时, 请提供清洁机的型号。

请记录您的型号: _____ 请记录您的购买日期: _____

注: 请保留好您的原始购买收据。在进行保修索赔时, 购买收据可用作购买日期的证明。请参阅“质保”以获取详细信息。



©2017 BISSELL Homecare, Inc.
Grand Rapids, Michigan
保留所有权利。中国印刷
文档编号 161-4090 12/17 RevC
访问我们的网站:
www.BISSELL.cn