

# STEAM SHOT™



2635 SERIES

# IMPORTANT SAFETY INSTRUCTIONS

## **READ ALL INSTRUCTIONS BEFORE USING YOUR STEAM MOP.**

When using an electrical appliance, basic precautions should be observed, including the following.



## **WARNING**

**ALWAYS CONNECT TO A PROPERLY EARTHED  
ELECTRICAL SOCKET.**



## **WARNING**

**TO REDUCE THE RISK OF FIRE, ELECTRIC  
SHOCK, OR INJURY:**

- » Unplug from electrical socket when not in use and before servicing.
- » This appliance can be used by persons with reduced physical, sensory or mental capabilities or lack of experience and knowledge if they have been given supervision or instruction concerning use of the appliance in a safe way and understand the hazards involved.
- » Children should be supervised to ensure that they do not play with the appliance.
- » If the supply cable is damaged, it must be replaced by the manufacturer, its service agent or similarly qualified persons in order to avoid a hazard.
- » Liquid or steam must not be directed towards equipment containing electrical components.
- » The appliance shall not be left unattended while it is connected to the supply mains.
- » The appliance is not to be used if it has been dropped, if there are visible signs of damage or if it is leaking.
- » Keep the appliance out of reach of children when it is energized or cooling down.
- » The foot surfaces are liable to get hot during use.
- » Do not leave appliance when plugged in.
- » Do not modify earthed plug.
- » To reduce the risk of electric shock: Use indoors only. Do not expose to rain. Store indoors.
- » Do not allow to be used as a toy.
- » Use only as described in this user guide.
- » Use only manufacturer's recommended attachments.
- » Do not use with damaged cable or plug.
- » Do not immerse in water or liquid.
- » If appliance is not working as it should, has been dropped, damaged, left outdoors, or dropped into water; do not attempt to operate it and have it repaired at an authorized service center.
- » Liquid or steam must not be directed towards equipment containing electrical components.
- » Do not pull or carry by cable, use cable as a handle, close door on cable, or pull cable around sharp edges or corners.
- » Do not run appliance over cable.
- » Keep cable away from heated surfaces.
- » To unplug, grasp the plug, not the cable.
- » Do not handle plug or appliance with wet hands.
- » Do not put any object into openings.
- » Turn off all controls before unplugging.
- » Use extra care when cleaning on stairs.
- » Do not use appliance in an enclosed space filled with vapors given off by oil base paint, paint thinner, some mothproofing substances, flammable dust, or other explosive or toxic vapors.
- » Keep appliance on a level surface.
- » If your appliance is fitted with a nonrewireable BS 1363 plug it must not be used unless a 13 amp (ASTA approved to BS 1362) fuse is fitted in the carrier contained in the plug. Spares may be obtained from your BISSELL supplier. If for any reason the plug is cut off, it must be disposed of, as it is an electric shock hazard should it be inserted into a 13 amp socket.



## **WARNING**

**SURFACE MAY BE HOT. AVOID CONTACT.**



**THIS SYMBOL MEANS  
WARNING: DANGER OF SCALDING**

**FOR OPERATION ON A 220-240 VOLT A.C. 50/60 HZ POWER SUPPLY ONLY.**

This model is for household use only.

## **SAVE THESE INSTRUCTIONS**

# Thanks for buying a BISSELL steam cleaner

We're glad you purchased a BISSELL steam cleaner. Everything we know about floor care went into the design and construction of this complete, high-tech home cleaning system.

Your BISSELL steam cleaner is well made, and we back it with a limited two-year guarantee. We also stand behind it with a knowledgeable, dedicated Consumer Care department, so, should you ever have a problem, you'll receive fast, considerate assistance.

My great-grandfather invented the floor sweeper in 1876. Today, BISSELL is a global leader in the design, manufacture, and service of high quality homecare products like your BISSELL steam cleaner.

Thanks again, from all of us  
at BISSELL.

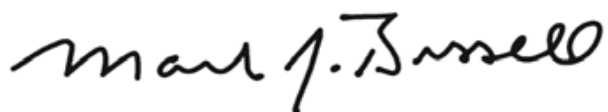

Mark J. Bissell  
Chairman & CEO

Safety Instructions.....	2
Product View.....	4
Operations .....	5-6
Notes .....	7
Guarantee.....	8
Consumer Care.....	8

# Product View

- 1 Safety Cap
- 2 Steam Trigger
- 3 Indicator Light
- 4 Power Cable
- 5 Extension Hose
- 6 Accessory Nozzle
- 7 Detail Brush Tool
- 8 Flat Scraping Tool
- 9 Angle Concentrator Tool
- 10 Grout Brush Tool
- 11 Window Squeegee Tool



\*Product image may vary



## **WARNING**

Plastic film can be dangerous. To avoid danger of suffocation, keep away from babies and children.

## **WARNING**

Do not plug in your steam cleaner until you are familiar with all instructions and operating procedures.

## **WARNING**

To reduce the risk of electric shock, turn power switch off and disconnect polarized plug from electrical outlet before performing maintenance.

# Operations

## Filling with water

1. Push down on the safety cap while turning anti-clockwise.
2. Fill measuring cup to the max fill line.
3. Slowly pour water into steamer.

**NOTE: Do not add anything except cool water or you will cause damage to the heating element and void your warranty.**

4. Replace the safety cap by pushing down while turning clockwise.

If your tap water contains a high level of mineral content (hard water) the use of distilled or demineralised water is recommended.

## Power cable

Unwrap power cable before operating unit.

## Indicator light

The red indicator light will go on when the unit is first plugged in. When the steamer is ready to use, the light will turn off.

## Steam trigger

Push to release steam.

In order to refill the water tank after emptied, the trigger must be engaged to release all the steam/pressure that may be built up. Press the trigger to release all the steam/pressure.

## Tools and accessories\*

The accessory nozzle can be attached directly to the steamer or the end of the extension hose.

The accessory nozzle and extension hose attached in the same manner. Align the arrow on the tool with the (I) mark on the Steam Shot™ and turn clockwise until the arrow aligns with the (II) mark on the steamer.

### A. Extension hose

For cleaning hard to reach areas. Attach to unit and use with the accessory nozzle attached.

### B. Accessory nozzle

Attach to unit or hose. Use alone or with a tool attached

### C. Detail brush tool

Attach to end of the accessory nozzle for scrubbing stubborn soil. Color coded for specific use.

### d. Flat scraping tool

Attach to the end of accessory nozzle for removing wallpaper, gum and extra sticky messes.

### e. Angle concentrator tool

Attach to end of the accessory nozzle.

## ⚠ WARNING

Always unplug your Steam Shot™ before filling/refilling. Press trigger until steamer depressurises. Wait 5 minutes before removing cap.

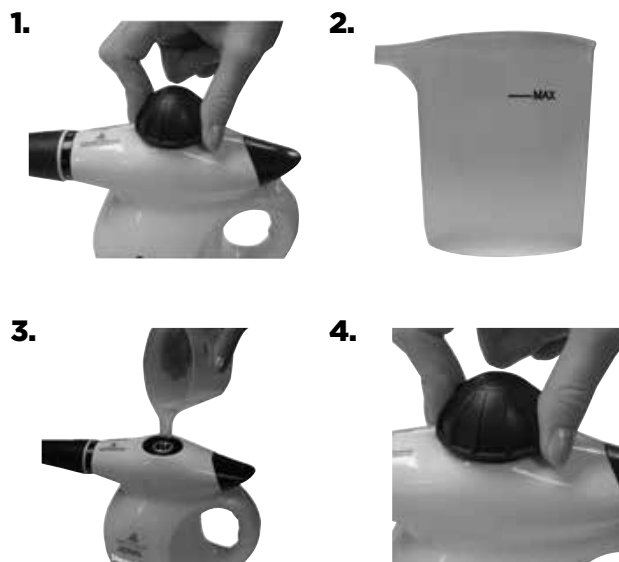

## ⚠ WARNING

Before disconnecting a tool from the steam cleaner, make certain that steam is no longer coming from the nozzle. Use an oven mitt to remove tools, or wait until they cool before removing.

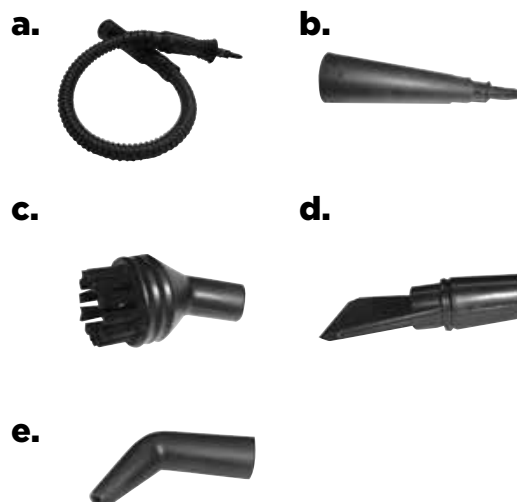

\*Tools and accessories vary by model.

# Operations

## f. Grout brush tool

Attach to end of the accessory nozzle for scrubbing small cracks and crevices.

## g. Fabric steamer tool

Attach to end of the accessory nozzle for refreshing and removing wrinkles on clothing or drapes. Attach cloth over tool.

## h. Window squeegee tool

Hooks onto the fabric steamer tool (without cloth) for glass and window cleaning.

f.



g.



h.

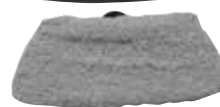

\*Tools and accessories vary by model

## Steam cleaning all living areas

Stubborn soil that resists traditional hot water, cleaning solutions and vigorous scrubbing can often be effectively removed with high temperature steam. Baked-on grease on the stovetop, dried fruit juice in the refrigerator, stubborn soap scum on sliding shower doors, gum on countertops — steam makes all these far easier to clean. Use your Steam Shot™ to soften and remove stubborn dirt, grime, dry, hardened food, and other household soil from hard surfaces. You can also use your steam cleaner to clean pet cages.

**NOTE: Always remove pets before cleaning.**

1. Fill with cool tap water or distilled/demineralized water.
2. Connect the plug to an appropriate outlet.
3. When red indicator light turns off, the steamer is ready to use. Press trigger to release steam.
4. Wipe surface with a clean, dry cloth.

In order to refill the water tank after emptied, the trigger must be engaged to release all the steam/pressure that may be built up. Press the trigger to release all the steam/pressure.

## Steaming/freshening clothes

Use your Steam Shot™ to remove wrinkles from clothes, and “freshen” clothing that has been stored. Test for color fastness in a hidden area. If color is affected do not use.

1. Hang clothing from a shower rod or clothes hook using a sturdy clothes hanger.
2. Fill with cool tap water or distilled/demineralized water.
3. Connect plug to an appropriate outlet.
4. Attach the fabric steamer tool with pad attached.
5. Press trigger to release steam.
6. Move over fabric taking care not to concentrate steam in a single area.



## WARNING

Keep face and all exposed skin away from steam. Failure to do so may result in personal injury.



## WARNING

Thermal shock can shatter glass. Before cleaning cold glass surface, carefully warm the surface by directing the steam jet on the glass from a distance of no less than 4 - 6”.

## Tip

**Your Steam Shot™ is a very versatile tool.**

**Use it to:**

- » Give your houseplants a refreshing cool cloud mist by using at 12” or more away from plants.
- » Soften gum or adhesives for easier removal.
- » Soften glazing putty on windows for easier removal.
- » Clean grills.
- » Clean coolers.
- » Clean sink garbage disposals.
- » Clean exhaust fan reusable filters (always remove from fixture before cleaning).

# Notes



# Consumer Guarantee

This Guarantee only applies outside of the USA and Canada. It is provided by BISSELL International Trading Company BV ("BISSELL").

This Guarantee is provided by BISSELL. It gives you specific rights. It is offered as an additional benefit to your rights under law. You also have other rights under law which may vary from country to country. You can find out about your legal rights and remedies by contacting your local consumer advice service. Nothing in this Guarantee will replace or lessen any of your legal rights or remedies. If you need additional instruction regarding this Guarantee or have questions regarding what it may cover, please contact BISSELL Consumer Care or contact your local distributor.

This Guarantee is given to the original purchaser of the product from new and is not transferable. You must be able to evidence the date of purchase in order to claim under this Guarantee.

## Limited Two-Year Guarantee

Subject to the \*EXCEPTIONS AND EXCLUSIONS identified below, BISSELL will for two years from the date of purchase by the original purchaser repair or replace (with new or remanufactured components or products), at BISSELL's option, free of charge, any defective or malfunctioning part or product.

BISSELL recommends that the original packaging and evidence of the date of purchase be kept for the duration of the Guarantee period in case the need arises within the period to claim on the Guarantee. Keeping the original packaging will assist with any necessary re-packaging and transportation but is not a condition of the Guarantee.

If for your product is replaced by BISSELL under this Guarantee, the new item will benefit from the remainder of the term of this Guarantee (calculated from the date of the original purchase). The period of this Guarantee shall not be extended whether or not your product is repaired or replaced.

### \*EXCEPTIONS AND EXCLUSIONS FROM THE TERMS OF THE GUARANTEE

This Guarantee applies to products used for personal domestic use and not commercial or hire purposes. Consumable components such as filters, belts and mop pads, which must be replaced or serviced by the user from time to time, are not covered by this Guarantee.

This Guarantee does not apply to any defect arising from fair wear and tear. Damage or malfunction caused by the user or any third party whether as a result of accident, negligence, abuse, neglect, or any other use not in accordance with the User Guide is not covered by this Guarantee.

An unauthorised repair (or attempted repair) may void this Guarantee whether or not damage has been caused by that repair/attempt.

Removing or tampering with the Product Rating Label on the product or rendering it illegible will void this Guarantee.

SAVE AS SET OUT BELOW BISSELL AND ITS DISTRIBUTORS ARE NOT LIABLE FOR ANY LOSS OR DAMAGE THAT IS NOT FORESEEABLE OR FOR INCIDENTAL OR CONSEQUENTIAL DAMAGES OF ANY NATURE ASSOCIATED WITH THE USE OF THIS PRODUCT INCLUDING WITHOUT LIMITATION LOSS OF PROFIT, LOSS OF BUSINESS, BUSINESS INTERRUPTION, LOSS OF OPPORTUNITY, DISTRESS, INCONVENIENCE OR DISAPPOINTMENT. SAVE AS SET OUT BELOW BISSELL'S LIABILITY WILL NOT EXCEED THE PURCHASE PRICE OF THE PRODUCT.

BISSELL DOES NOT EXCLUDE OR LIMIT IN ANY WAY ITS LIABILITY FOR (A) DEATH OR PERSONAL INJURY CAUSED BY OUR NEGLIGENCE OR THE NEGLIGENCE OF OUR EMPLOYEES, AGENTS OR SUBCONTRACTORS; (B) FRAUD OR FRAUDULENT MISREPRESENTATION; (C) OR FOR ANY OTHER MATTER WHICH CANNOT BE EXCLUDED OR LIMITED UNDER LAW.

## Consumer Care

**If your BISSELL product should require service or to claim under our Limited Two-Year Guarantee, please contact us as follows:**

### Website:

[www.BISSELL.com](http://www.BISSELL.com)

### Mail:

BISSELL International Trading Company B.V.  
Stadhouderskade 55  
1072 AB Amsterdam  
The Netherlands

## Visit the BISSELL website: [www.BISSELL.com](http://www.BISSELL.com)

When contacting BISSELL, have model number of cleaner available.

Please record your Model Number: \_\_\_\_\_ Please record your Purchase Date: \_\_\_\_\_

**NOTE: Please keep your original sales receipt. It provides proof of the date of purchase in the event of a Guarantee claim. See Guarantee for details.**



©2016 BISSELL Homecare, Inc.  
Grand Rapids, Michigan  
All rights reserved. Printed in China  
Part Number 161-0175 10/16  
Visit our website at: [www.BISSELL.com](http://www.BISSELL.com)



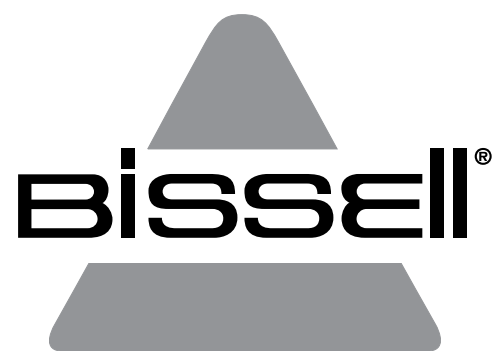

# STEAM SHOT™ 蒸汽喷壶



2635Z

# 重要安全须知

使用蒸汽拖把清洁机之前，请先阅读所有安全须知。

使用电气设备时，应遵照基本预防措施，包括以下内容：



**警告**

务必连接至正确接地的电源插座。



**警告**

为降低火灾、电击或伤害风险，请遵照以下要求操作：

- » 不用时以及维修本装置前，应先将插头从电源插座中拔出。
- » 本装置可由身体、感官或心智机能不健全者或者缺乏经验和了解的人员使用，但前提是有人监护他们，或告知他们本装置的安全使用方法及相关危险。
- » 应监护好儿童，确保其不会玩耍本装置。
- » 如果电源线损坏，必须由制造商及其维修机构或类似有资格的人员更换，以免发生危险。
- » 液体或蒸汽不能直接朝向容纳电气部件的装置，例如烘箱内部。

- » 连接电源时，本装置不得处于无人看管的状态。
- » 如果本装置曾掉落在地上、存在明显损坏的迹象或者发生漏液，请勿使用本装置。
- » 在本装置通电时或冷却过程中，确保让儿童远离本装置。
- » 在使用期间，支脚表面容易变热。
- » 插上插头时，切勿让本装置处于无人看管的状态。
- » 切勿改装接地插头。
- » 为降低电击风险，请遵照以下要求进行操作：仅在室内使用。切勿淋雨。请在室内存放。
- » 切勿当做玩具使用。
- » 务必按本使用手册中的规定使用本装置。
- » 务必使用制造商推荐的配件。
- » 切勿使用损坏的电缆或插头。
- » 切勿浸入水中或液体中。
- » 如果本装置无法正常工作、曾掉落在地上、已损坏、曾置于室外或掉落在水中，请勿尝试进行操作，而是将其送至授权维修中心进行修理。
- » 不得将液体或蒸汽导入到包含电气部件的设备中。
- » 切勿拽拉电缆或通过电缆提起设备，切勿将电缆用作把手，切勿在关门时夹住电缆，切勿在锋利的边缘或拐角区域拽拉电缆。
- » 请勿让本装置压过电缆。
- » 确保电缆远离受热表面。
- » 要拔下插头，请捏住插头，而不是电缆。
- » 切勿用湿手握持插头或本装置。
- » 切勿将任何物体放入开口中。
- » 拔下插头前，请先关闭所有控制器。
- » 清扫楼梯时应格外小心。
- » 切勿在充满油性漆所发出的蒸气、油漆稀释剂或某些防蛀性物质、可燃性粉尘或其他爆炸性或有毒蒸气的密闭空间内使用本装置。
- » 确保将本装置放在水平表面上。



**警告**

表面可能会变热。请勿触摸。



此符号表示

警告：烫伤危险

仅适合在 **220-240 V 50/60 Hz** 的交流电源下操作。

本型号仅供家庭使用。

## 请保管好本安全须知，以备将来参考

# 感谢您购买必胜蒸汽清洁机

非常高兴您购买必胜蒸汽清洁机。我们了解一切与地板护理有关的知识，藉此设计并制造出这一功能完备的高科技家用清洁设备。

这款必胜蒸汽清洁机品质优良，并享有两年有限保修。此外，我们还拥有知识丰富、爱岗敬业的客户服务团队，他们非常乐于为您提供相应的服务。无论您在使用过程中遇到什么问题，都能很快获得我们周到的专业服务。

我的曾祖父于 1876 年发明了地板清扫机。时至今日，必胜在设计、制造和服务领域已成为优质家居产品（如必胜蒸汽清洁机）的全球领导者。

必胜公司全体员工再次向您表示衷心感谢。

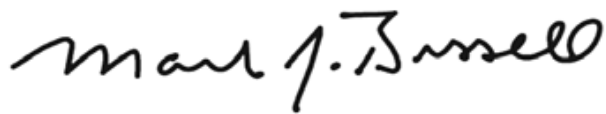

Mark J. Bissell  
董事长兼首席执行官

安全须知 .....	2
产品视图 .....	4
操作 .....	5-6
备注 .....	7
保修 .....	8
客户服务 .....	8

# 产品视图

- 1 安全帽
- 2 蒸汽扳机
- 3 指示灯
- 4 电源线
- 5 延长软管
- 6 喷嘴配件
- 7 细毛刷
- 8 扁头刮刀
- 9 弯头集中器
- 10 砂浆缝隙清洁刷
- 11 擦窗器



\*实际产品图像可能会有所不同



## 警告

塑料薄膜可导致危险。应让婴幼儿远离塑料薄膜，以免发生窒息。

## 警告

在熟悉所有说明和操作过程之前，切勿接通蒸汽清洁机的电源。

## 警告

为降低电击风险，在执行维护之前，请先关闭电源，然后将极性插头从电源插座中拔出。

# 操作

## 注水

1. 在按下安全帽的同时逆时针转动。

2. 向量杯中加水至最大水位线。

3. 慢慢将水注入蒸汽清洁机中。

注：除冷水外，不要添加其他任何东西，否则会损坏加热元件并导致保修失效。

4. 更换安全帽时，请将其按住并顺时针转动。

如果自来水中含有大量矿物质（硬水），则建议使用蒸馏水或脱矿物质水。

## 电源线

操作本装置前，请展开电源线。

## 指示灯

本装置刚通电时，红色指示灯将亮起。当蒸汽清洁机准备就绪后，该指示灯将熄灭。

## 蒸汽扳机

按下可喷出蒸汽。

为了给空的水箱重新加水，必须按住扳机，从而释放可能积聚在里面的所有蒸汽/压力。请按下扳机，释放所有蒸汽/压力。

## 工具和配件\*

喷嘴配件可以直接安装在蒸汽清洁机上或延长软管的末端。

喷嘴配件和延长软管的安装方式相同。将工具上的箭头与 Steam Shot™ 上的 (I) 标记对准，然后顺时针转动，直至箭头与蒸汽清洁机上的 (II) 标记对准。

### A. 延长软管

用于清洁难以够到的区域。安装在本装置上，与喷嘴配件一起使用。

### B. 喷嘴配件

安装在蒸汽清洁机或软管上。单独使用或安装在工具上。

### C. 细毛刷

安装在喷嘴配件的末端，用于清除顽固污垢。采用颜色编码，以便用于专用目的。

### d. 扁头刮刀

安装在喷嘴配件的末端，用于清理墙纸、口香糖及超粘的污垢。

### e. 弯头集中器

安装在喷嘴配件的末端。

\*工具和配件会因型号而异

## 警告

注水/重新注水之前，务必拔下 Steam Shot™ 的插头。按下扳机，直到蒸汽清洁机完成泄压。等待5分钟，然后取下安全帽。

1.



2.



3.



4.

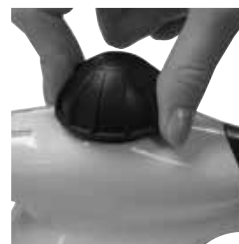

## 警告

在从蒸汽清洁机上断开工具之前，应确保喷嘴中不再喷出蒸汽。用烤箱手套将工具卸下，或等到它们冷却后再卸下。

a.



b.



c.



d.



e.



# 操作

## f. 砂浆缝隙清洁刷

安装在喷嘴配件的末端，用于洗刷细纹和裂缝。

## g. 织物蒸汽清洁头

安装在喷嘴配件的末端，用于翻新衣物或窗帘以及去除上面的褶皱。工具的前面要用布罩上。

## h. 擦窗器

钩在织物蒸汽清洁头上（去掉布），用于清洁玻璃和窗子。

f.



g.



h.



\*工具和配件会因型号而异

## 蒸汽清洁所有生活区

对于顽固污垢而言，一般的热水、清洁剂以及反复的搓洗都无能为力，但高温蒸汽却可以将其一扫而光。无论是炉子上的烘焙油脂、冰箱里的干果汁、淋浴门上的顽固皂垢，还是台面上的口香糖——蒸汽令这一切变得更加容易清洁。利用 Steam Shot™ 可以软化并去除硬式表面上的顽固污渍、尘垢、干硬食品及其他家庭污垢。此外，蒸汽清洁机还可以用于清洁宠物笼子。

注：清洁前，务必先将宠物从笼中取出。

1. 加注凉自来水或蒸馏水/脱矿质水。
2. 将插头连接到合适的插座上。
3. 当红色指示灯熄灭时，便可以使用蒸汽清洁机。按下扳机可喷出蒸汽。
4. 用洁净的干布擦拭表面。

为了给空的水箱重新加水，必须按住扳机，从而释放可能积聚在里面的所有蒸汽/压力。请按下扳机，释放所有蒸汽/压力。

## 用蒸汽清洁/翻新衣物

利用 Steam Shot™ 可以去除衣物上的褶皱，并对贮存的衣服进行“翻新”。在隐蔽的区域做一下试验，确保不会褪色。如果颜色受到影响，请勿使用。

1. 用坚固的衣架将衣服挂在淋浴杆或衣帽钩上。
2. 加注凉自来水或蒸馏水/脱矿质水。
3. 将插头连接到合适的插座上。
4. 安装拖把垫，然后安装织物蒸汽清洁头。
5. 按下扳机可喷出蒸汽。
6. 移动织物，注意不要让蒸汽集中在一个区域。

### 警告



不要让蒸汽对着脸和暴露的皮肤。否则可能导致人身伤害。

### 警告



温度骤升可导致玻璃破碎。在清洁冷的玻璃表面之前，请在距离不小于4-6英寸的地方对着玻璃喷射蒸汽，以便将表面温热。

## 小贴士

Steam Shot™ 堪称为“多面手”。

它可以：

- » 在距离12英寸或以上的地方为盆栽植物提供一个清爽的云雾环境。
- » 软化口香糖或粘合剂，从而更便于清除。
- » 软化窗子上的玻璃油灰，从而更便于清除。
- » 清洗烤架。
- » 清洁冷藏箱。
- » 清理水槽垃圾处理系统。
- » 清洁排气扇上可反复使用的过滤器（清洁前务必先从夹具上卸下）。

# 备注



# 质保

此质保仅适用于美国和加拿大以外的国家/地区。此质保由 BISSELL International Trading Company BV ( “必胜” ) 提供。

此质保由必胜提供。它赋予您在法律规定权利之外的特定权利。不同国家/地区的用户所享有的法律权利也会有所不同。具体法律权利和救济方法可联系当地客户服务中心。本质保中的任何内容不会取代或减少您的法律权利或救济方法。如需有关此质保的附加说明或对其承保范围有任何疑问，请联系必胜客户服务中心或当地的分销商。

此质保提供给新品购买者，且不可转让。如需依据此质保进行索赔，必须提供购买日期凭证。

## 两年有限保修

除以下“例外事项”外，自原购买者购买之日起两年内，必胜有权自行决定免费维修或更换（使用新的或翻新的部件或产品）任何有缺陷或发生故障的零件或产品。

必胜建议客户在质保期内妥善保管产品原包装及购买日期凭证，以备索赔时举证。保留原包装会方便必要的重新包装和运输，但不是索赔的必要条件。

如果必胜在质保期内为您更换产品，则所更换产品的质保期为本质保的剩余时间（自原购买日期算起）。无论您的产品是更换还是维修，质保期都不会延长。

### \*质保条款的“例外事项”

此质保适用于个人家庭使用的产品，不适用于商用或租赁用产品。滤水器、皮带和拖把垫等需要用户不时更换或保养的易耗品不在质保范围以内。

此质保不适用于正常磨损导致的缺陷。用户或任何第三方因事故、疏忽、滥用或其他任何不符合《使用手册》的使用行为而导致的损坏或故障不在质保范围以内。

任何未经授权的维修（或尝试维修），无论是否造成损坏，都可能导致此质保失效。

撕下或篡改产品标签或导致标签不可辨识会导致此质保失效。

除下列明示的事项外，必胜及其分销商不对不可预见的损失或损坏，或者任何与本产品使用有关的附带和间接损失或损坏负责，包括但不限于利润损失、商业损失、营业中断、机会损失、困境、不便或失望。除下列明示的事项外，必胜的责任不会超过产品购买价。

必胜不会以任何形式免除或限制自身对以下事项的责任：（A）因我方、我方员工、代理商或分包商的疏忽而导致的死亡或人身伤害；（B）欺诈或虚假陈述；（C）其他法律所无法免除或限制的责任。

# 客户服务

如果您的必胜产品需要维修或要依据两年有限保修进行索赔，请通过以下方式联系我们：

## 网站：

[www.BISSELL.com](http://www.BISSELL.com)

## 来信：

BISSELL International Trading Company B.V.  
Stadhouderskade 55  
1072 AB Amsterdam  
The Netherlands

**访问必胜网站：[www.BISSELL.com](http://www.BISSELL.com)**

联系必胜时，请提供清洁机的型号。

请记录您的型号：\_\_\_\_\_ 请记录您的购买日期：\_\_\_\_\_

注：请保留好您的原始购买收据。在进行保修索赔时，购买收据可用作购买日期的证明。请参阅“质保”以获取详细信息。



©2016 BISSELL Homecare, Inc.  
Grand Rapids, Michigan  
保留所有权利。中国印刷  
文档编号 16I-0175 10/16  
访问我们的网站：[www.BISSELL.com](http://www.BISSELL.com)